

Guardian | Downlight | 198-264 V AC | powerLED 7,2 W DC - 8,5 W AC

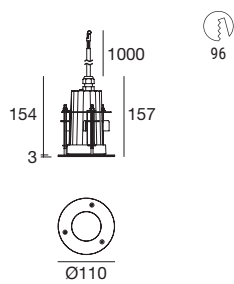
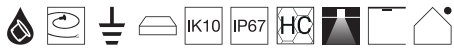

		Cct	lm S - D	Optic
White	81893	M 2700	760 - 568	15 Spot (17°)
Black	81916	W 3000	760 - 568	30 Flood (26°)
Grey	81838	N 4000	821 - 613	60 W.Flood (51°)
				07 Asymm. -

		Cct	lm S - D	Optic
White	81894	M 2700	760 - 453	15 Spot (14°)
Black	81917	W 3000	760 - 453	30 Spot (24°)
Grey	81839	N 4000	821 - 489	60 Flood (42°)

Recessed casing Pag. 5

Guardian_J | Downlight | 198-264 V AC | powerLED 7,2 W DC - 8,5 W AC

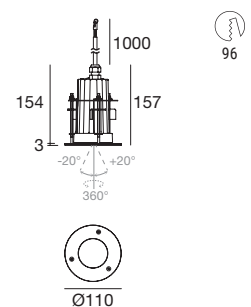

		Cct	lm S - D	Optic
White	81895	M 2700	760 - 558	20 Spot (20°)
Black	81918	W 3000	760 - 558	30 Flood (30°)
Grey	81840	N 4000	821 - 603	60 W.Flood (60°)

Recessed casing Pag. 5

81909W07

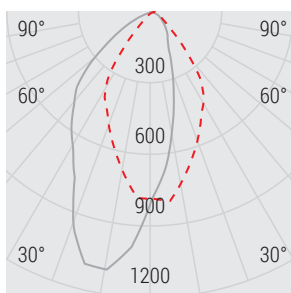

Photometric curve

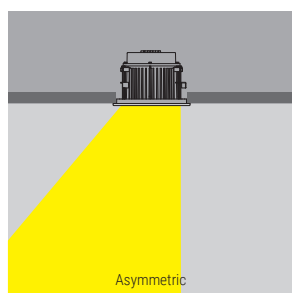

Light beam



3,1 mt

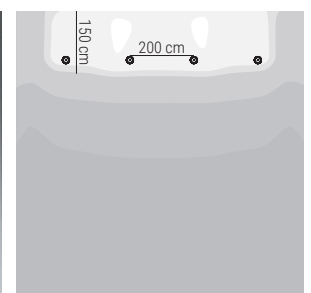

Floor plan

Guardian | Downlight | 198-264 V AC | arrayLED 12,6 W DC - 14,1 W AC

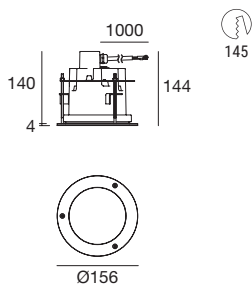

		Cct	lm S - D	Optic
White	81896	M 2700	1843 - 1098	15 Spot (14°)
Black	81919	W 3000	1921 - 1144	30 Flood (33°)
Grey	81841	N 4000	2028 - 1208	60 W.Flood (64°)

		Cct	lm S - D	Optic
White	81899	M 2700	1683 - 769	07 Asymm. -
Black	81922	W 3000	1808 - 800	
Grey	81844	N 4000	1949 - 846	

		HC	Cct	lm S - D	Optic
White	81897	M 2700	1843 - 668	15 Spot (14°)	
Black	81920	W 3000	1921 - 696	30 Flood (29°)	
Grey	81842	N 4000	2028 - 735	60 W.Flood (50°)	

Recessed casing Pag. 5

Guardian_J | Downlight | 198-264 V AC | arrayLED 12,6 W DC - 14,1 W AC

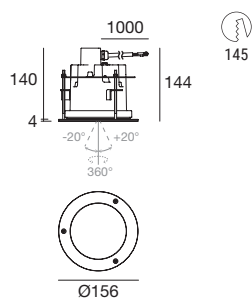

		Cct	lm S - D	Optic
White	81904	M 2700	1843 - 978	15 Spot (16°)
Black	81927	W 3000	1921 - 1020	35 Flood (30°)
Grey	81849	N 4000	2028 - 1077	45 W.Flood (46°)

Recessed casing Pag. 5

Guardian | Downlight | 198-264 V AC | arrayLED 12,6 W DC - 14,1 W AC

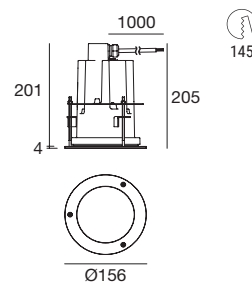

		Cct	lm S - D	Optic
White	81900	M 2700	1843 - 1098	15 Spot (14°)
Black	81923	W 3000	1921 - 1144	30 Flood (33°)
Grey	81845	N 4000	2028 - 1208	60 W.Flood (64°)

		Cct	lm S - D	Optic
White	81903	M 2700	1683 - 769	07 Asymm. -
Black	81926	W 3000	1808 - 800	
Grey	81848	N 4000	1949 - 846	

		HC	Cct	lm S - D	Optic
White	81901	M 2700	1849 - 668	15 Spot (14°)	
Black	81924	W 3000	1921 - 696	30 Flood (29°)	
Grey	81846	N 4000	2028 - 735	60 W.Flood (50°)	

Recessed casing Pag. 5

Guardian_J | Downlight | 198-264 V AC | arrayLED 12,6 W DC - 14,1 W AC

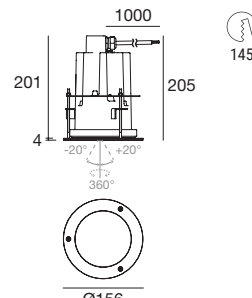

		Cct	lm S - D	Optic
White	81905	M 2700	1843 - 978	15 Spot (16°)
Black	81928	W 3000	1921 - 1020	35 Flood (30°)
Grey	81850	N 4000	2028 - 1077	45 W.Flood (46°)

Recessed casing Pag. 5

Guardian | Downlight | 198-264 V AC | arrayLED 30 W DC - 33,6 W AC

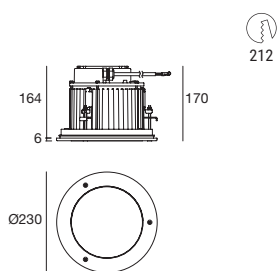

	Cct	Im S - D	Optic
White 81906	M 2700	4088 - 3159	15 Spot (18°)
Black 81929	W 3000	4372 - 3293	30 Flood (32°)
Grey 81867	N 4000	4702 - 3475	60 W.Flood (57°)

	Cct	Im S - D	Optic
White 81909	M 2700	3167 - 1408	07 Asymm. -
Black 81932	W 3000	3401 - 1467	
Grey 81870	N 4000	3667 - 1548	

	HC	Cct	Im S - D	Optic
White 81907	M 2700	4088 - 1743	15 Spot (18°)	
Black 81930	W 3000	4372 - 1816	30 Flood (28°)	
Grey 81868	N 4000	4702 - 1918	60 W.Flood (42°)	

Recessed casing Pag. 5

Guardian_J | Downlight | 198-264 V AC | arrayLED 30 W DC - 33,6 W AC

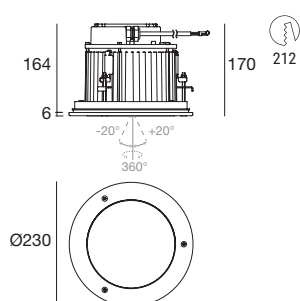

	Cct	Im S - D	Optic
White 81914	M 2700	4088 - 2945	15 Spot (18°)
Black 81937	W 3000	4372 - 3068	35 Flood (34°)
Grey 81875	N 4000	4702 - 3240	45 W.Flood (58°)

Recessed casing Pag. 5

Recessed casing for brick or concrete-mounted installation

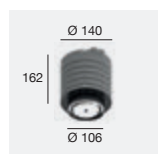

description
99673 Recessed casing suitable for: Guardian 7,2W / Guardian_J 7,2W



description
83048 Recessed casing suitable for: Guardian DALI 12,6W / Guardian_J DALI 12,6W

Guardian | Downlight | 198-264 V AC | arrayLED 30 W DC - 33,6 W AC

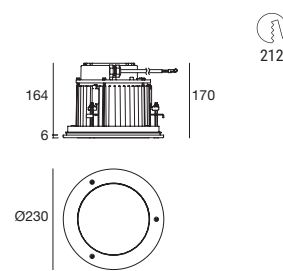

DALI	Cct	Im S - D	Optic
White 81910	M 2700	4088 - 3159	15 Spot (18°)
Black 81933	W 3000	4372 - 3293	30 Flood (32°)
Grey 81871	N 4000	4702 - On req	60 W.Flood (57°)

DALI	Cct	Im S - D	Optic
White 81913	M 2700	3167 - 1408	07 Asymm. -
Black 81936	W 3000	3401 - 1467	
Grey 81874	N 4000	3667 - 1548	

DALI	HC	Cct	Im S - D	Optic
White 81911	M 2700	4088 - 1743	15 Spot (18°)	
Black 81934	W 3000	4372 - 1816	30 Flood (28°)	
Grey 81872	N 4000	4702 - 1918	60 W.Flood (42°)	

Recessed casing Pag. 5

Guardian_J | Downlight | 198-264 V AC | arrayLED 30 W DC - 33,6 W AC

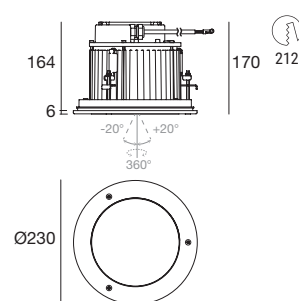
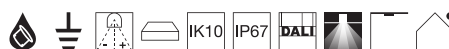

DALI	Cct	Im S - D	Optic
White 81915	M 2700	4088 - 2945	15 Spot (18°)
Black 81938	W 3000	4372 - 3068	35 Flood (34°)
Grey 81876	N 4000	4702 - 3240	45 W.Flood (58°)

Recessed casing Pag. 5

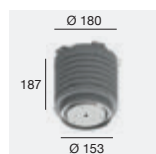

description
99674 Recessed casing suitable for: Guardian 12,6W / Guardian_J 12,6W

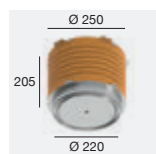

description
99675 Recessed casing suitable for: Guardian 30W / Guardian DALI 30W Guardian_J 30W / Guardian_J DALI 30W